

#	DESCRIPTION	PART NUMBER	QTY
1	Silenziatore / Muffler - dB killer 50.DK.020.0	OVAL 300	1
2	Tubo di raccordo / Link pipe	9773M015S2	1
3	Fascetta con bussola / Pipe clamp with bush	50.73.1076.0	1
4	Fascetta con bussola / Pipe clamp with bush	50.73.795.0	1
5	Carter in carbonio / Carbon cover	50.CR.053.1	1
6	Vite M5 x 8 / Screw M5 x 8	50.73.233.1	2
7	Vite M8x70 / Screw M8x70	50.73.086.1	1
8	Rondella in alluminio / Aluminium washer	50.73.291.1	1
9	Distanziale in alluminio / Aluminium spacer (Øe.30)	50.SS.056.1	1
10	Dado M8 flangiato / Flanged nut M8	50.73.393.1	1
11	Dado M6 / Nut M6	50.73.146.1	2
12	Rondella M6 / Washer M6	50.72.027.1	4
13	Vite M6 x 12 / Screw M6 x 12	50.72.024.1	2
14	Staffa / Bracket	50.SS.031.0	1
15	Protezione in gomma per staffa / Rubber protection	50.73.077.1	1
16	Molla media / Mid-size spring	50.73.359.1	1
17	Tubo in gomma per molla / Rubber pipe for spring	50.73.049.0	1

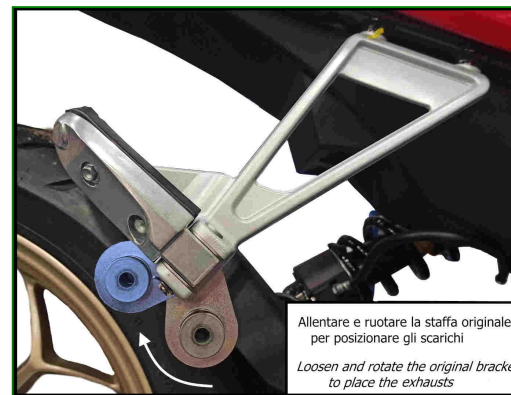

Allentare e ruotare la staffa originale per posizionare gli scarichi
Loosen and rotate the original bracket to place the exhausts

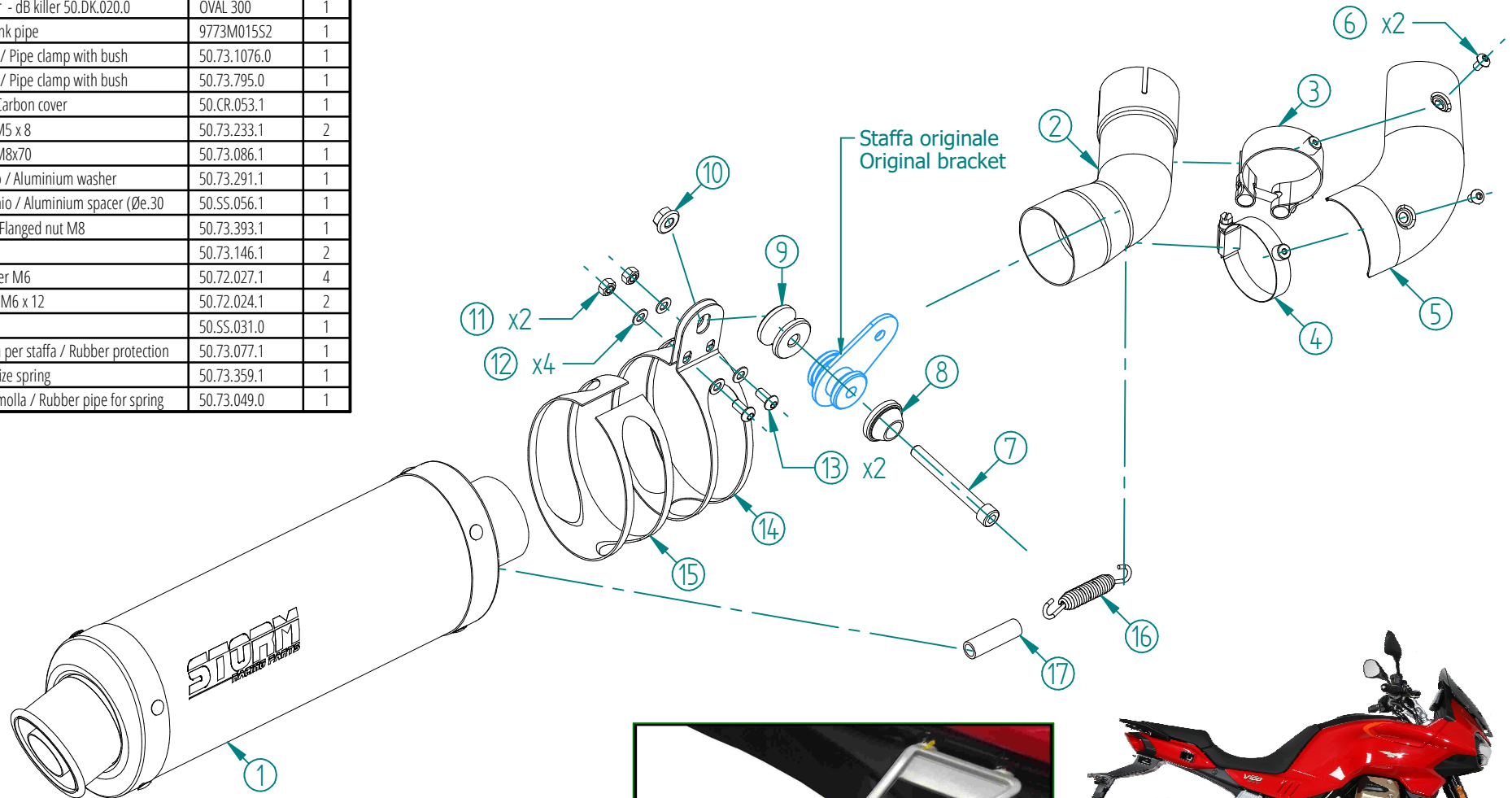

APPLICAZIONI / APPLICATIONS			
CODICE / CODE	SILENZIATORE / MUFFLER	TUBO / PIPE	FASCETTA / CLAMP
74.M.015.LX1	INOX / ST. STEEL	INOX / ST. STEEL	INOX / ST. STEEL
74.M.015.LX1B	STEEL BLACK		